

Installation Instructions

Mechanical OPC

Part No. 5600422

Fits Ferris 36" CCW Walk-Behind Mowers

Kit Contents					
Part No.	Qty.	Description	Part No.	Qty.	Description
5406756B	1	WELD, OPC MOUNT, CCW36	5021841	2	GRIP, FOAM, .940 X 5 X .187
5102497	1	ROD, OPC CONNECTION, CCW	5043425B	1	WELD, OPERATOR PRESENCE, LH
5406720	1	WIRE JUMPER, CCW OPC	5025010X24	1	BOLT, 1/4-20 X 3", GD5
5102495	2	LINKAGE, ADJUSTER	5025391	3	NUT, 1/4-20 HEX NYLOCK FLANGE
5025034	4	NUT, 3/8-16 HEX	5025063X3	2	SET SCREW, 3/8-16 X 3/8
5025010X8	2	BOLT, 1/4-20 X 1 GD5 YZ	5025154	2	WASHER, 1/4 SAE
5020637	1	SPRING, COMPRESSION	5025214X8	1	PIN, CLEVIS, 3/8 X 1
5021490	1	GRIP, VINYL, 1/2 X 4	5102634	1	BUSHING, FLANGE 3/8ID X 1/2 LONG

⚠ WARNING



Remove the ignition key prior to performing maintenance on the unit.

Before beginning any service work turn off the PTO, engage the parking brake, turn off the ignition, remove the ignition key, and disconnect the spark plug wire(s).

Removing the Electronic OPC

1. Park the machine on a flat, level surface. Turn off the PTO, engage the parking brake, turn off the ignition, remove the ignition key, and disconnect the spark plug wire(s).
2. Remove the four (4) 5/16-18 X 3/4" bolts (**B, Figure 1**) that secure the handle bar cover (**A**) and remove the cover from the unit.
3. Disconnect the three (3) wires from bottom of the Magura electronic box (**A, Figure 2**).
4. Using the wire jumper (**B**) connect the black wire and white/red wire as shown in Figure 2, leaving the orange/white wire disconnected.
5. Unbolt the Magura electronic box from the unit and remove it along with the wires running up to the grips.

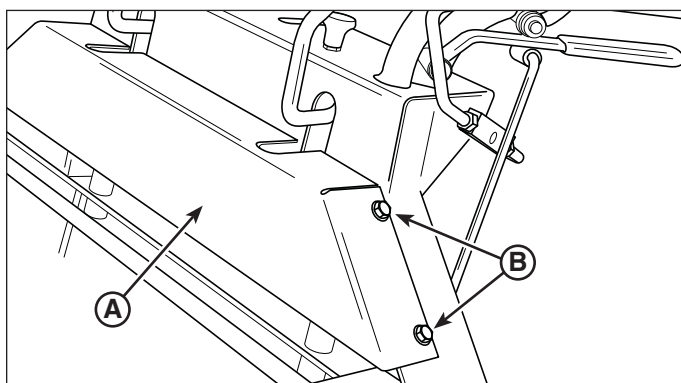

Figure 1. Removing the Handle Bar Cover
A. Handle Bar Cover
B. 5/16-18 X 3/4" Bolt

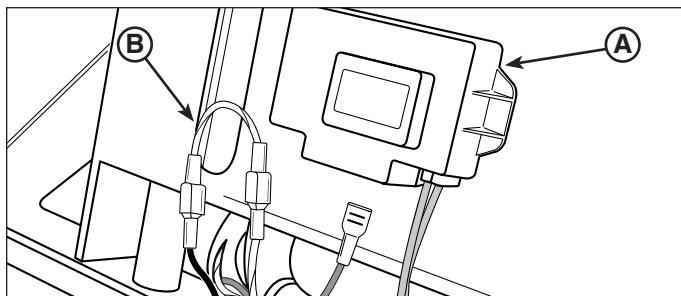

Figure 2. Disconnecting the Wire Harness
A. Magura Electronic Box
B. Wire Jumper

Removing the Electronic OPC Continued...

6. Loosen and remove the 3/8" set screw (A, Figure 3) from the adjuster linkage.
7. Remove the OPC override handle (B) from the welded OPC switch tab, be sure to leave the switch tab in place for installation of the mechanical OPC.
8. Loosen and remove the allen head screw (A, Figure 4) and nut that secure the Magura grip (B) to the handle bars.
9. Remove the Magura grip by sliding it off the end of the handle bars.
10. Repeat steps 8 & 9 to the other side of the machine.
11. Install the new foam grips.

Installing The Mechanical OPC

1. Preassemble the mechanical OPC by threading a 3/8" lock nut (B, Figure 5) onto the OPC handle (A).
2. Thread the OPC handle into the adjuster linkage (C) until the end of the threads are one half of an inch (0.50") from the linkage as shown in Figure 5.
3. Tighten down the 3/8" lock nut.
4. Thread a second 3/8" lock nut onto the OPC connector rod (E).
5. Thread the OPC connector rod into the adjuster linkage until the backside of the rod is two inches (2.00") from the linkage as shown in Figure 5.
6. Tighten down the 3/8" lock nut.
7. Loosely thread the 3/8" set screw (D) into the adjuster linkage.
8. Repeat these steps to the other side of the OPC connector rod.

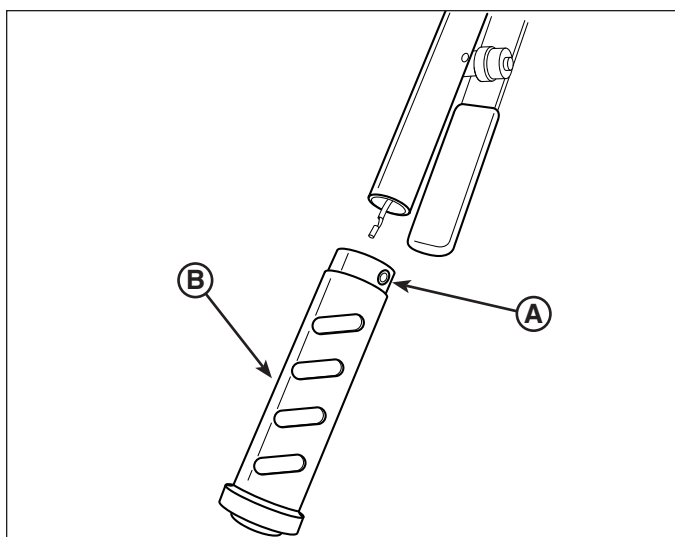

Figure 4. Removing the Magura OPC Grip
A. Allen Head Screw
B. Magura Grip

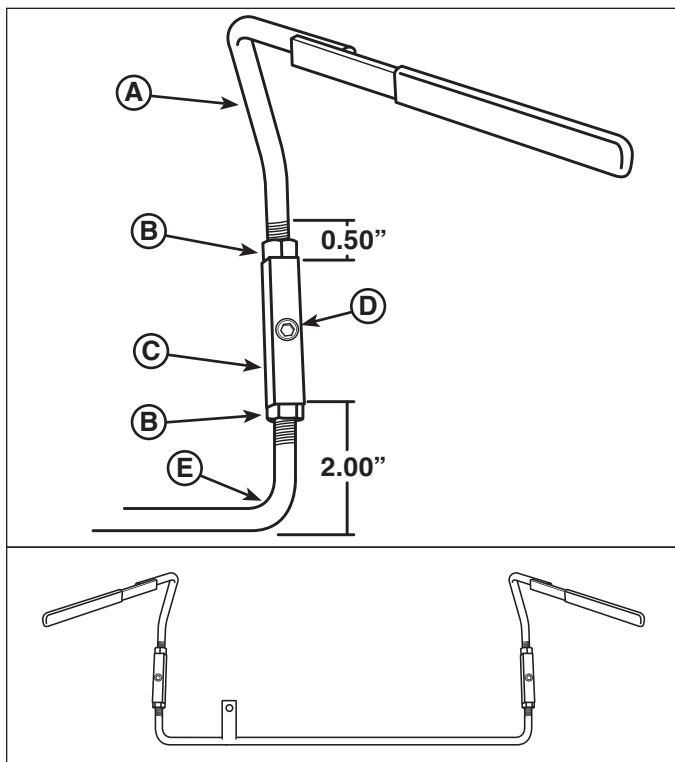

Figure 5. Preassemble The Mechanical OPC
A. OPC Handle
B. 3/8" Lock Nut
C. Adjuster Linkage
D. 3/8" Set Screw
E. OPC Connector Rod

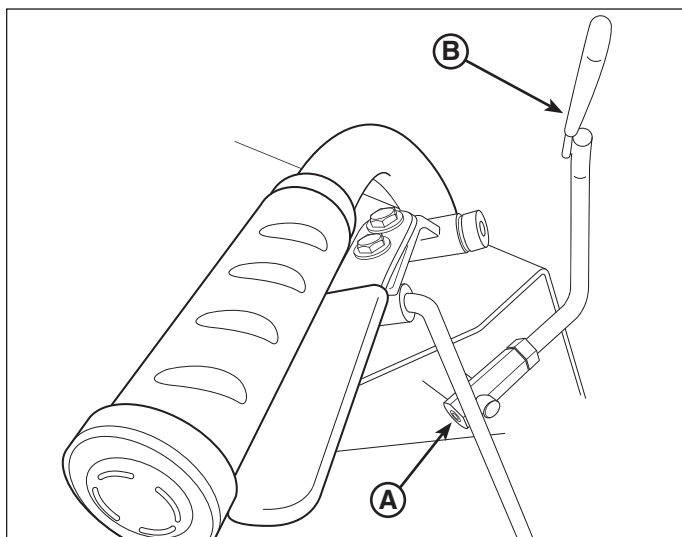

Figure 3. Removing the OPC Override Handle
A. 3/8" Set Screw
B. OPC Handle

Installing The Mechanical OPC Continued...

9. While holding the mounting bracket (A, Figure 6) in place, use the slots as guides to mark the location of the holes to be drilled (B). See Figure 6
 10. Drill the two (2) 17/64 (.266") holes through the handle bars.
 11. Install the mounting bracket (H, Figure 7) to the machine using two (2) 1/4" X 1" bolts and washers (A), secure them with two 1/4" nylock flange nuts (B).
 12. Install a 1/4" X 3" bolt (D) up through the bottom of the mounting bracket (H), through the spring (C) and through the tab in the OPC connector rod (E), secure the bolt with a 1/4" nylock flange nut (B). See Figure 7.
 13. Install the adjuster linkage onto the existing welded OPC switch tab on the right side of the unit, then insert the new 3/8" X 1" clevis pin (F) through the other adjuster linkage and into the mounting bracket on the left hand side of the unit.
- NOTE: The plastic flange bushing should be installed into the mounting bracket before installing the clevis pin.*
14. Tighten down the 3/8" set screw (G) into the adjuster linkage on the left side of the unit.
 15. With the new mechanical OPC handles in the down position, push and hold the OPC switch tab (A, Figure 8) up into the switch (B).
 16. Tighten down the 3/8" set screw into the adjuster linkage on the right hand side of the unit.
 17. Check for proper operation.

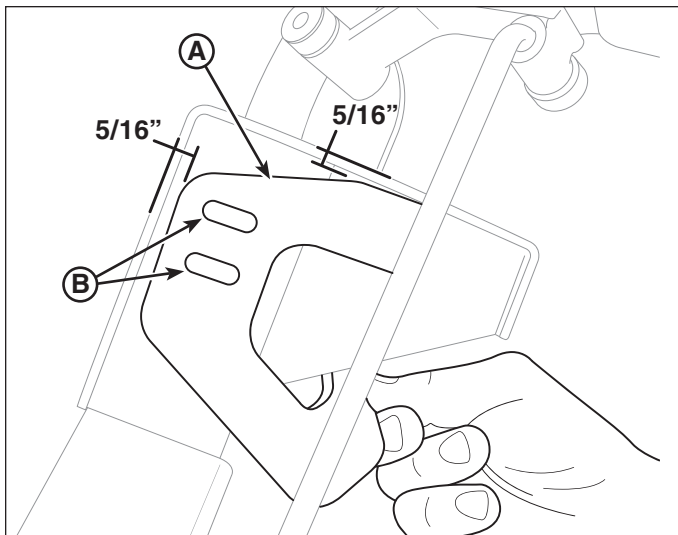

Figure 6. Drilling The Holes For Mounting
A. Mounting Bracket
B. Holes To Be Drilled

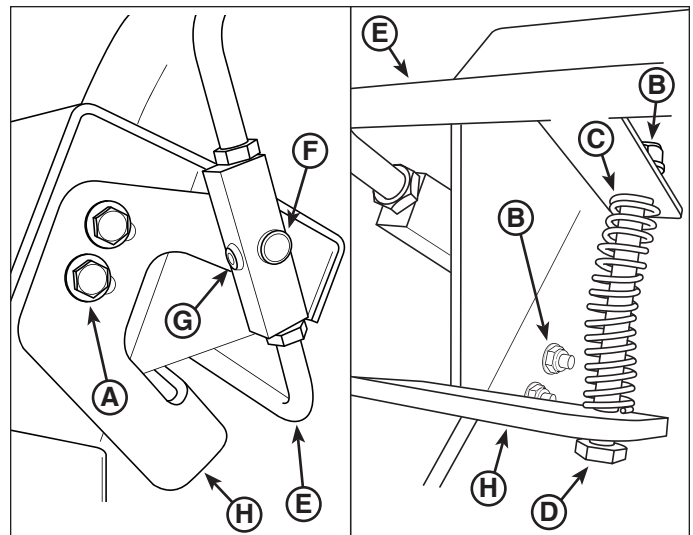

Figure 7. Installing the Mounting Bracket

- A. 1/4" X 3/4" Bolt & Washer**
- B. 1/4" Nylock Flange Nut**
- C. Spring**
- D. 1/4" X 3" Bolt**
- E. OPC Connector Rod**
- F. 3/8" X 1" Clevis Pin**
- G. 3/8" Set Screw**
- H. Mounting Bracket**

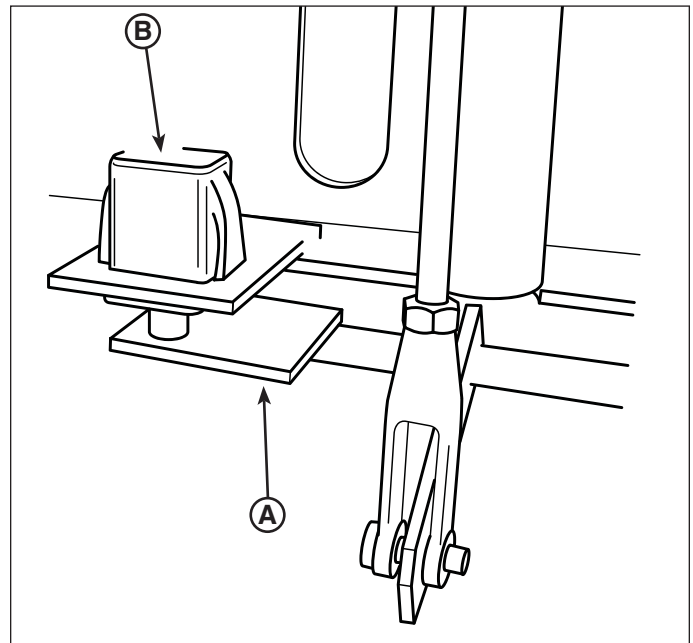

Figure 8. OPC Switch
A. OPC Switch Tab
B. Switch