

May 2001

TOPIC: AIR CLEANER SUPPORT BRACKET

MODELS

AFFECTED: IS4000Z/D31
Serial No. 226-275

Ferris Industries has determined that the machines listed above were shipped with the incorrect air cleaner support bracket. To rectify this problem, an Air Cleaner Support Kit (46610) is available to update the support bracket to current production standards.

This kit includes all the necessary hardware and detailed instructions to perform this update.

Please note, this is a mandatory fix.

\$10 labor will be paid.



Installation Instructions

Air Cleaner Support Bracket Part No. 46610

For IS4000Z/D31, serial no. 226 - 275

Contents:

Part No.	Qty.	Description
46389	1	Air Cleaner Support Bracket
25335	2	M8 x 35mm Bolt
25170	2	5/16 Lock Washer
25155	2	5/16 Flat Washer
25127	2	5/16-18 Serrated Flange Nut
25011-6	2	5/16-18 x 3/4 Bolt

WARNING

Before beginning any service work turn off the PTO, set the parking brake, turn off the ignition, and disconnect the spark plug wire(s).

Air Cleaner Support Bracket Removal

1. Loosen the hose clamp (A, Figure 1) on the engine's air intake hose.
2. Remove the 5/16" hardware that fastens the air cleaner support bracket to the air cleaner.
3. Remove the air cleaner from the intake manifold.
4. Remove the two (2) 8mm metric bolts (C, Figure 1) that fasten the air cleaner support bracket (B, Figure 1) to the engine block and discard them.
5. Remove the air cleaner support bracket and discard the bracket.

Air Cleaner Support Bracket Installation

1. Fasten the new air cleaner support bracket to the engine with the two (2) 8mm X 35mm metric bolts and lock washers provided, but do not tighten (see Figure 1).
2. Install the air intake hose onto the intake manifold and align the mounting holes in the air cleaner with holes on the air cleaner support bracket.
3. Using the 5/16 X 3/4" bolts, washers and flange nuts, attach the air cleaner support bracket to the air cleaner (see Figure 2). Make sure the throttle and choke cables are routed through the shaded area in Figure 2.
4. Reposition the hose clamp on the air intake hose and tighten (see Figure 1).
5. Tighten the 8mm metric bolts that fasten the support bracket to the engine.

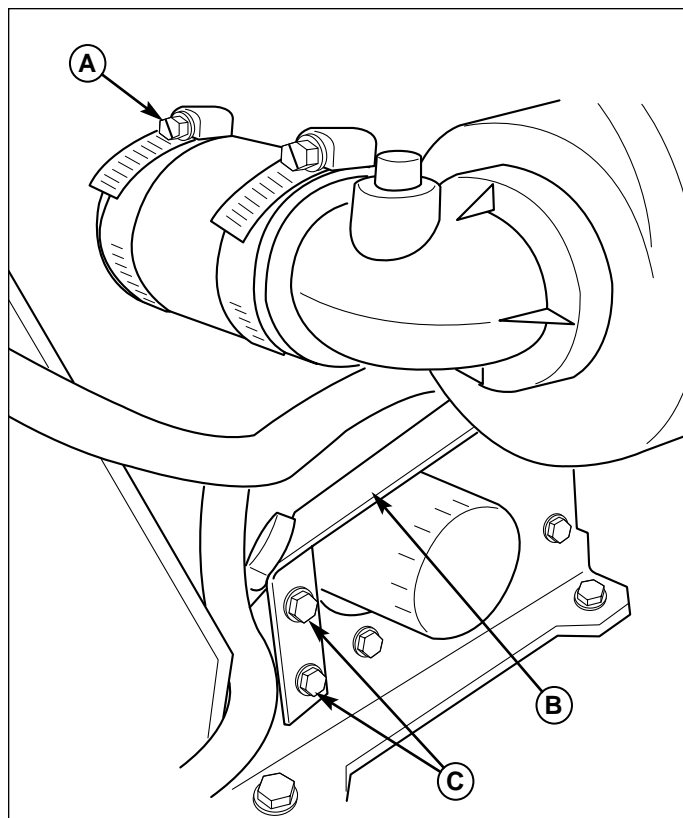

Figure 1. Air Cleaner Support Bracket

- A. Hose Clamp
- B. Air Cleaner Support Bracket
- C. 8mm Bolts & Washers

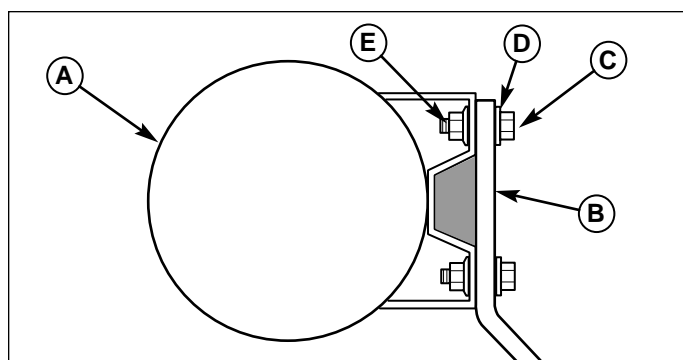

Figure 2. Air Cleaner Support Bracket Installation

- A. Air Cleaner
- B. Air Cleaner Support Bracket
- C. 5/16 x 3/4" Bolt
- D. 5/16" Washer
- E. 5/16" Flange Nut