



March 2003

### TOPIC: DIFFICULT TO PUSH (FREE-WHEEL) MOWER WITH TRANSMISSION IN NEUTRAL

#### MODELS

**AFFECTED:** HC32KAV13 - S/N: 101-510

Ferris Industries has determined that the mower may be difficult to push with the transmission's hydraulic release rod in the neutral position. This is due to an incorrectly adjusted parking brake linkage rod.

To test if adjustment is necessary, first move the hydraulic release rod into the neutral position (see Figure 1). Push on the mower's handle bars while slowly pulling down on the operator presence handles.

- If the machine starts to move with ease then becomes difficult again as the operator presence handles touch the handle bars, you must shorten the linkage rod.
- If pushing the machine never becomes easy after the operator presence handles touch the handle bars, you need to lengthen the linkage rod.

Two-tenths (0.2) hour labor will be paid.

#### ROD ADJUSTMENT

1. Move the hydraulic release rod into the neutral position. (See Figure 1)
2. Loosen the jam nut (C, Figure 2) that secures the clevis on the lower end of the linkage rod (B).
3. Remove the set collar (A) that fastens the linkage rod (B) to the operator presence linkage tab.
4. Turn the rod 1-2 full revolutions. (Turn clockwise to shorten; counter-clockwise to lengthen)
5. Reinstall the rod into the linkage tab and secure with the set collar.
6. Grasp the operator presence / parking brake handles and the handle bar grips at the same time to disengage the parking brake.
7. Attempt to push the mower. If it is still difficult, repeat Step 3 - 5.
8. After making adjustment, tighten the jam nut against the clevis.

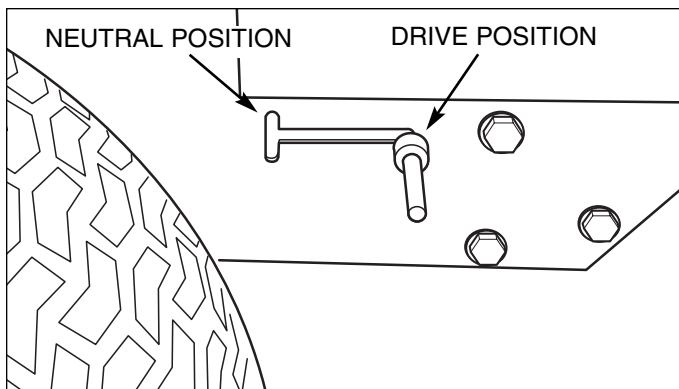

Figure 1. Hydraulic Release Rod

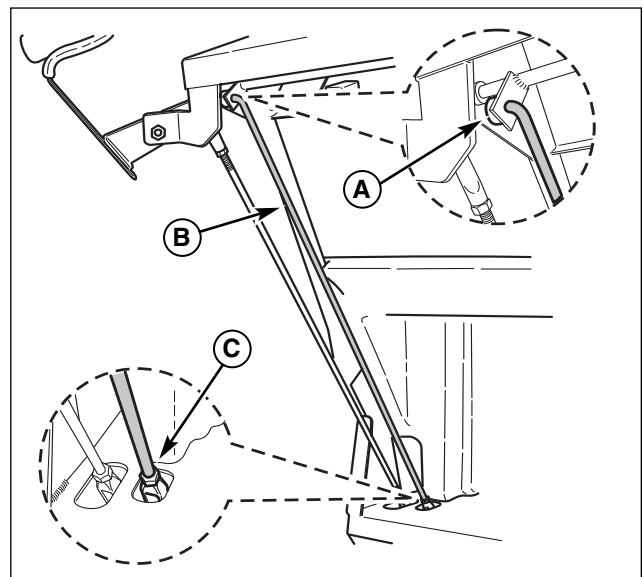

Figure 2. Brake Linkage Rod Adjustment