



F098

SERVICE BULLETIN

# MANDATORY UPDATE

MAY 2008

## Wheel Motor Cotter Pin and Castellated Axle Nut Replacement

MODELS AFFECTED			
Brands	Part Nos.:	Serial No. Range:	Description:
Ferris	5900640, 5900704, 5900729, 5900730, 5900740	2012886071 to 2013107409	IS500Z Series Zero-Turn Riding Mowers
Ferris	5900605, 5900606, 5900607, 5900710, 5900711, 5900712, 5900739	2012886071 to 2013107409	IS1500Z Series Zero-Turn Riding Mowers
Ferris	5900619, 5901170, 5900624, 5900625, 5900629, 5900670, 5900713, 5900714, 5900715, 5900737, 5900738, 5900750, 5900754	2012886071 to 2013107409	IS2000Z Series Zero-Turn Riding Mowers

### DETAIL

Quality audits indicate that units within the serial number range listed above could potentially have a material issue with the wheel motor castellated axle nuts. **The wheel motor cotter pins and castellated axle nuts must be replaced on the affected units.**

### INSPECTION

Some units were updated prior to being shipped. If you have an affected unit please perform the inspection procedure detailed below before moving on to the corrective procedure.

1. Park the machine on a flat, level surface. Disengage the PTO, engage the parking brake and turn off the engine.
2. Inspect the wheel motor axle shaft. If the end of the wheel motor axle shaft has a yellow line on it, no further action is required. **If the wheel motor axle shaft does not have a yellow line on it, continue with Step # 3.**

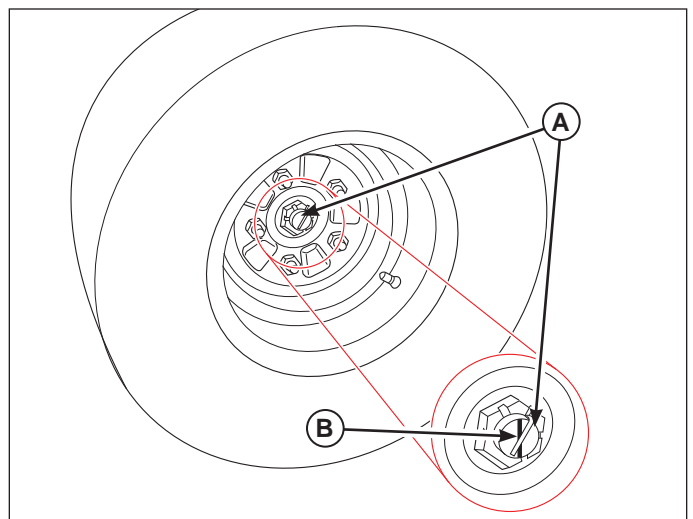

Figure 1. Inspecting the Castle Nut  
 A. Wheel Motor Axle Shaft  
 B. Yellow Line



3. Refer to Figure 2. Inspect the serial number of the wheel motor. **If the serial number falls in the range of 8046X - 8075X, continue with CORRECTIVE PROCEDURES.** If the serial number does not fall in the range of 8046X - 8075X no further action is required.

**CORRECTIVE PROCEDURES**

1. Order and install kit # 5600199.
2. Record the serial number of each wheel motor updated. See **Warranty Information.**

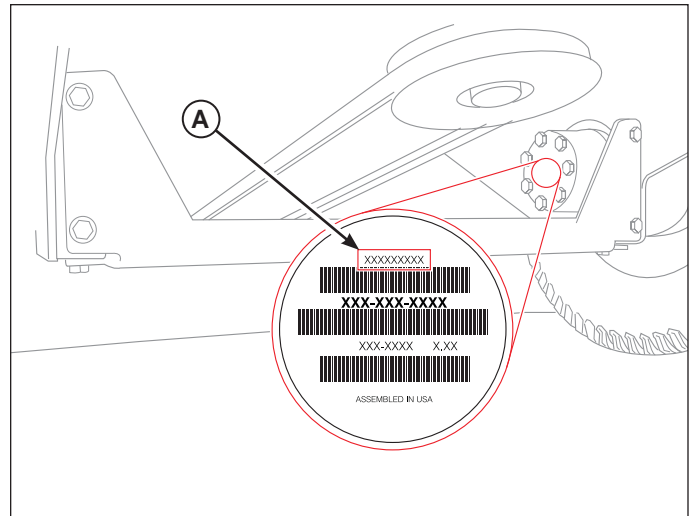

**Figure 2. Locating the Wheel Motor Serial Number**  
**A. Wheel Motor Serial Number**

**WARRANTY INFORMATION**

Fill in the Warranty Claim Form with the following information.

**IMPORTANT NOTE:**

In addition to the information below, **you must also include the serial number of the wheel motors that you update when filing your warranty claim.** See Figure 2 for the location of the serial number on your wheel motor. Include the wheel motor serial numbers in the “Component Serial Number / Date Code” box under the “Equipment Section” of your warranty claim.

Failure Location Category:	Hydraulic
Defective Part ID Code:	H65
Defect Code	BC
Control Number:	F098
Pickup & Delivery:	N/A
Total Hours:	0.2 (Inspection Only) 0.5 (Inspection & Repair)

Cause of Failure:	F098
Work Performed:	F098
Repair Parts:	5600199

WO 0XXXX

# Installation Instructions

## Castle Nut & Cotter Pin Replacement Kit

Part No. 5600199

For Ferris IS500Z, IS1500Z & IS2000Z Series

For Snapper Pro S150X & S200X Series

For Simplicity Citation & Cobalt Series

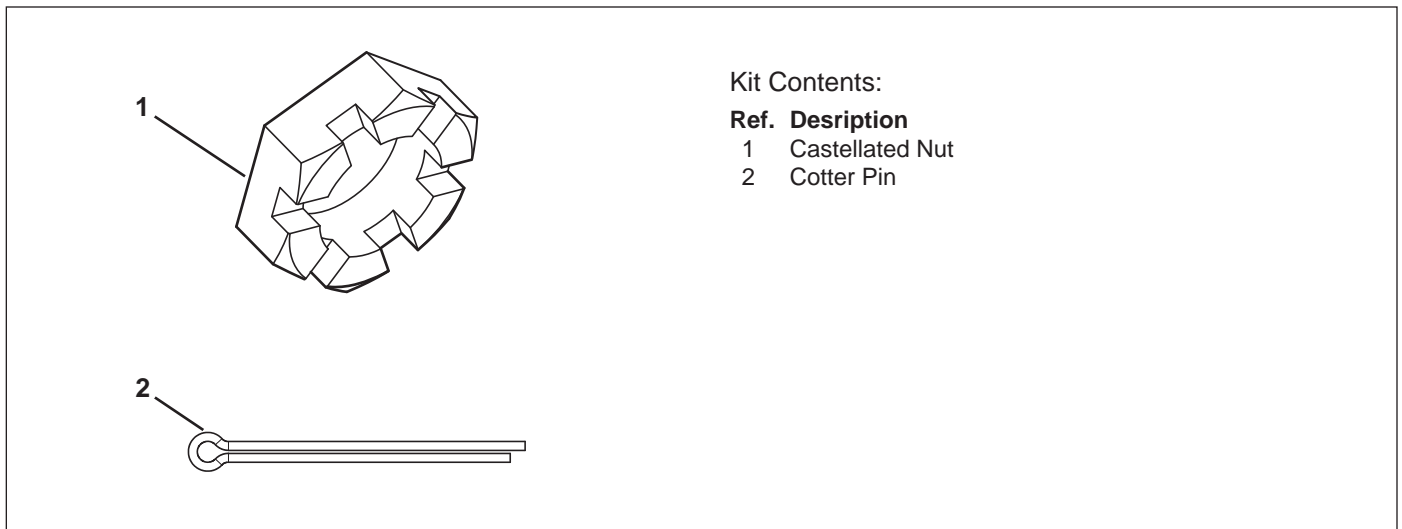

### Kit Contents:

#### Ref. Description

- 1 Castellated Nut
- 2 Cotter Pin

Figure 1. Contents

## WARNING

Before beginning any service work turn off the PTO, set the parking brake, turn off the ignition, and disconnect the spark plug wire(s).

## INSTALLATION

1. Park the unit on a smooth, level surface such as a concrete floor. Disengage the PTO, engage the parking brake, turn off the engine, and remove the ignition key.
2. Chock the wheels of the unit to prevent movement.
3. Position jack stands under both side of the rear of the machine. **Do not raise the unit.**
4. Remove the cotter pin (B, Figure 1) and the castellated nut (A). Discard both parts, they will not be reused.
5. Install the new castellated nut on the wheel motor. Torque the castellated nut to 120 ft. lbs (163 Nm).
6. Install the new cotter pin. Bend the long cotter pin leg counter-clockwise to mate with the castellated nut flat.
7. Repeat process for other side of unit.

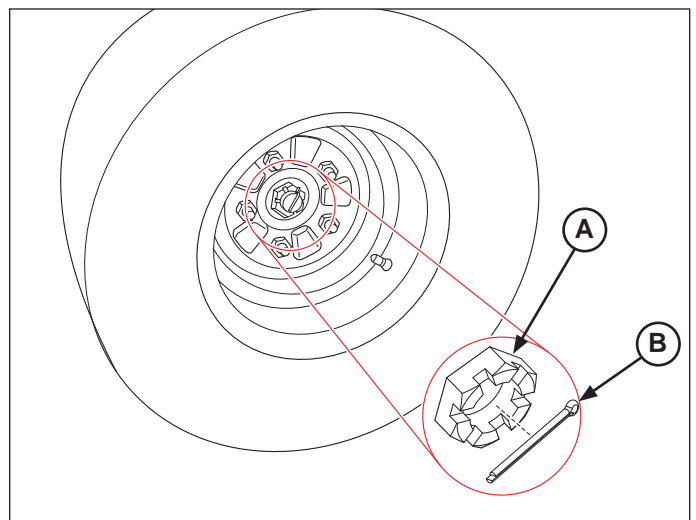

Figure 2. Installing the New Cotter Pin and Castellated Nut

A. Castellated Nut

B. Cotter Pin