

SERVICE**BULLETIN****SB #:** F103**BRANDS:****DATE:** MARCH 2010**TO:** ALL AUTHORIZED FERRIS DEALERS

SUBJECT: BLADE INSPECTION - AN INCORRECT ORIGINAL FACTORY INSTALLED BLADE MAY HAVE BEEN INSTALLED ON iCD MOWER DECKS. THE INCORRECT BLADE COULD HAVE A NEGATIVE AFFECT ON CUTTING PERFORMANCE.

MODELS: SEE LIST BELOW

Brand	Model Number	Serial Number Range	Description
Ferris	5900770, 5900841 & 5900842	2014112335 & Below	IS500Z Series Zero-Turn Riding Mowers
	5900832, 5900833 & 5900876		IS1500Z Series Zero-Turn Riding Mowers
	5900822, 5900823, 5900900 & 5900902		IS1500ZX Series Zero-Turn Riding Mower
	5900808, 5900879, 5900840, 5900811, 5900814, 5900807 & 5900816		IS2000Z Series Zero-Turn Riding Mower
	5900872, 5900873, 5900786, 5900787, 5900791, 5900793, 5900795, 5900788, 5900789, 5900718 & 5900794		IS3100Z Series Zero-Turn Riding Mower
	5900934		IS5100Z Series Zero-Turn Riding Mower
	5900858 & 5900930		Evolution Series Zero-Turn Riding Mower

DESCRIPTION

This bulletin details an inspection and correction procedure to make sure that the correct blades are installed on the unit.

INSPECTION

It is necessary to check the number stamped into the bottom of the blade before moving on to the corrective procedure. If you have an affected unit (see model and serial number ranges above), please perform the inspection procedure detailed below.

1. Park the machine on a flat, level surface. Disengage the PTO, engage the parking brake, turn off the engine, remove the spark plug wire(s) and wait for all moving parts to stop.
2. Inspect all three of the mower blades for the part number that is stamped into the blade. Refer to Figure 1 for the general location of the part number stamping.
3. Reference the chart below to see if your blade has the correct number stamped into it. **If the mower blade has any other number than what is shown below you MUST perform the CORRECTIVE PROCEDURE.**

Deck Size	Correct Mower Blade Part Number Stamping
52"	5101756
61"	5101755

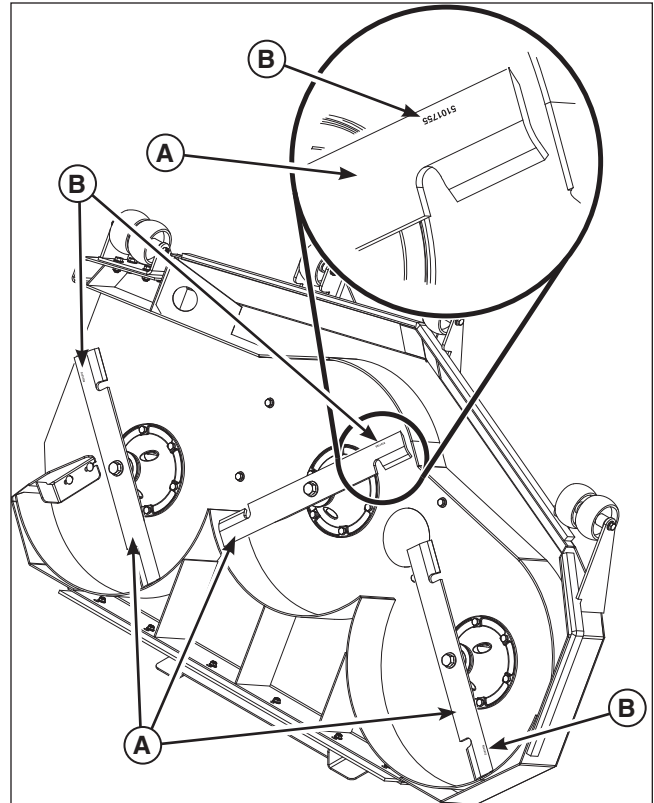

Figure 1. Mower Blade Part Number Stamping
A. Mower Blade
B. Mower Blade Part Number Stamping

CORRECTIVE PROCEDURES

1. Order and install a new blade set:
 For **52" Mower Decks ONLY** order: 5101756S.
 For **61" Mower Decks ONLY** order: 5101755S.

WARRANTY:

File for warranty reimbursement using e-Claim at www.ThePowerPortal.com. Use the values listed below when filling out the claim. The information in the "Brand" block indicates which tab the claim should be filed under. *Note: File only one unit per claim form.*

Brand	Ferris	Cause of Failure	F103
Failure Location Category	L&G Deck/Att.	Work Performed	F103
Failure Location Code	Spindle/Arbor F70	Repair Parts Used	5101756S (52" Models)
Defect Code/Failure Mode	AW		5101755S (61" Models)
Control/Evaluation Number	F103		
Pick-Up & Delivery	N/A		
Total Hours (Tenths)	Repair: 0.5		