

SERVICE**BULLETIN****SB #:** F112**BRANDS:****DATE:** AUGUST 2012**TO:** ALL AUTHORIZED FERRIS DEALERS**SUBJECT:** EXPORT UNITS ONLY - F800X SEAT SUSPENSION MODULE ORIENTATION AND SEAT STOP BOLT**MODELS:** SEE LIST BELOW

Brand	Model Numbers	Serial Number Range	Description
Ferris	5900911	2014510840 - 2015683607	F800X Series Outfront Zero-Turn Riding Mower

DESCRIPTION

This bulletin details an inspection and update procedure for export versions of the F800X series outfront zero-turn riding mowers to verify that the seat suspension module is orientated correctly and that the seat stop bolt is installed.

INSPECTION

- Seat Suspension Module:** Visually inspect the seat suspension module (**A**, **Figure 1**) on the seat plate (**B**) of the unit. If the seat adjustment knob (**C**) is on the bottom side closest to the seat plate, the orientation of the seat suspension module will need to be changed.

Seat Stop Bolt: Visually inspect the seat plate for the seat stop bolt (**D**) it should be installed in the right rear corner of the seat plate. If it is not there, one will need to be installed.

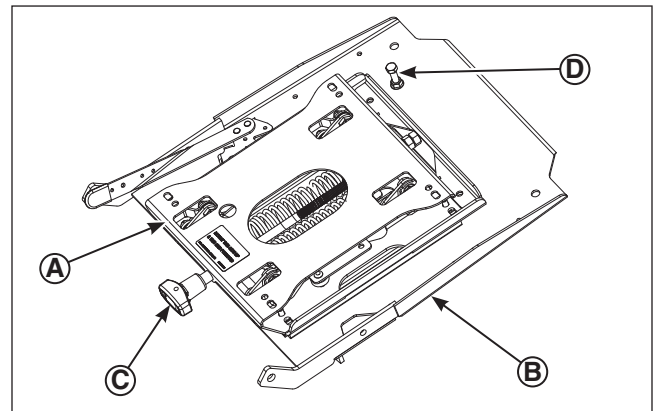

Figure 1. Inspection Procedure

CORRECTIVE PROCEDURES**Seat Suspension Module:**

- If the seat is installed, remove the four (4) nylock flange nuts that secure it to the seat suspension module and remove the seat.
- Remove the four (4) 5/16 X 1" button socket cap screws (**A**, **Figure 2**) and 5/16 flanged lock nuts (**B**) that secure the seat suspension module (**C**) to the slide rails (**D**).
- Flip the suspension module over so that the seat adjustment knob is on the top side so that it will be closest to the seat when it is installed. Secure using the hardware previously removed.
- Reinstall the seat and secure using the four (4) nylock flange nuts that is was previously installed with.

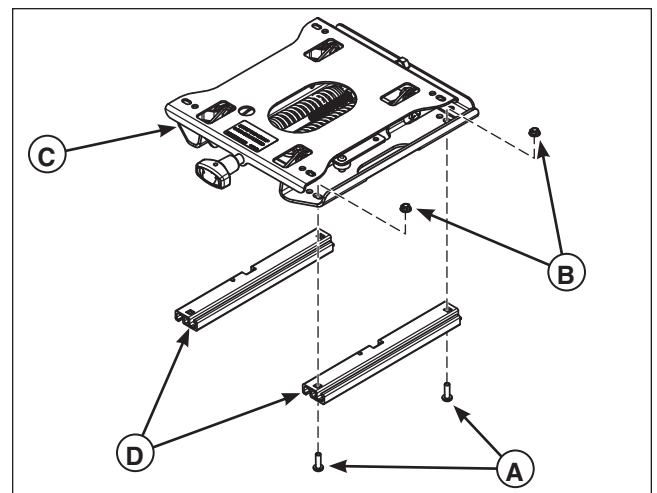

Figure 2. Correcting the Seat Suspension Module Orientation

Seat Stop Bolt:

1. Order and install the following hardware:

Ferris P/N	Description	Metric Size	Qty:
5025013X20	Bolt, 3/8-16 X 2-1/2 GD5 YZ	M8 - 1.25 X 64 mm	1
5025128	Nut, 3/8-16 Hex Serrated Flange	M8 - 1.25	1
5025394	Nut, 3/8-16 Hex Nylock Flange	M8 - 1.25	1

2. Raise the seat plate (**A, Figure 3**).
3. Install the 3/8-16 hex serrated flange nut (M8 - 1.25) (**B**) onto the 3/8-16 X 2-1/2 bolt (M8 - 1.25 X 64 mm) (**C**) as shown in Figure 3. The 3/8-16 hex serrated flange nut (M8 - 1.25) should be tightened until it contacts the non-threaded base of the bolt.
4. Install the bolt and nut through the seat plate in the hole as shown in Figure 3. Secure the bolt in place using the 3/8-16 hex nylock flange (M8 - 1.25)(**D**).
5. Lower the seat plate.

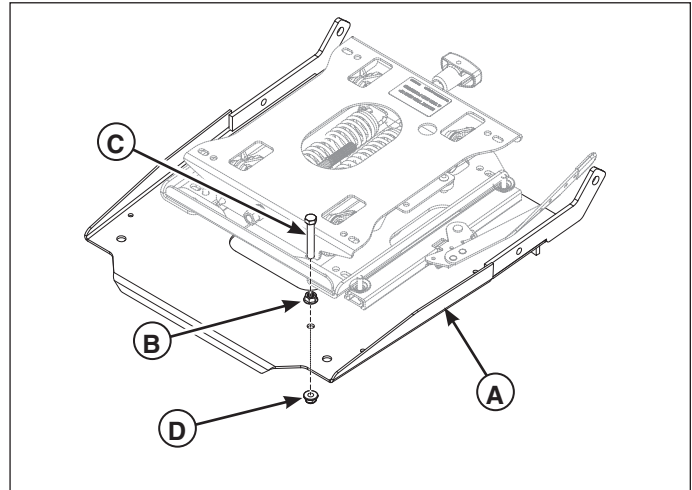

Figure 3. Installing the Seat Bolt (As seen from Right Rear Corner of Machine)

WARRANTY:

File for warranty reimbursement using e-Claim at www.ThePowerPortal.com. Use the values listed below when filling out the claim. The information in the "Brand" block indicates which tab the claim should be filed under. *Note: File only one unit per claim form.*

Brand	Ferris		
Failure Location Category	L&G Body/Chassis	Cause of Failure	F112
Failure Location Code	F69	Work Performed	F112
Defect Code/Failure Mode	AW	Repair Parts Used	5025013X20 (Qty: 1)
Control/Evaluation Number	F112		5025128 (Qty: 1)
Pick-Up & Delivery	N/A		5025394 (Qty: 1)
Total Hours (Tenths):	0.4		

BRIGGS & STRATTON POWER PRODUCTS GROUP, LLC
Distribution Sales & Customer Support