



Spindle Spacer Rings Available for 5061033 Spindles

Ferris has determined that some of the spindle assemblies, part number 5061033 (**A**, **Figure 1**), provided as service parts may not have been manufactured to our current specification and may require that they be installed with the spindle spacer ring, part number 5412403A (**B**). There is no material defect or increased risk of failure in these spindles. The spindle spacer ring has only been made available to ensure that all of the blades are positioned correctly to ensure an even cut.

To determine if you need a spindle spacer ring for your spindle, we have provided inspection procedures for checking shelf inventory of spindles and checking spindles installed in a mower deck. If you determine that the 5412403A spindle spacer ring is necessary, it is available at no charge through your normal parts source. All new 5061033 spindle assemblies with mounting rings measuring 1/2" (1,27 cm) that are shipped as service parts will include the spindle spacer ring.

Checking Shelf Inventory of 5061033 Spindle Housing

1. Measure the mounting ring (**A**, **Figure 2**) of the 5061033 spindle. A mounting ring that measures (**B**) approximately 1/2" (1,27 cm), may require a 5412403A spindle spacer ring when installed in the mower deck. A mounting ring that measures approximately 11/16" (1,75 cm) does not require a spindle spacer ring.

Checking Spindles Installed in a Mower Deck

1. Measure (**A**, **Figure 3**) from the bottom of the mower deck (**B**) to the bottom of the spindle mounting ring (**C**) to determine the thickness of the spindle you are replacing. If the measurement equals approximately 1/2" (1,27 cm) you can install a replacement spindle without the spindle spacer ring. If the measurement equals approximately 11/16" (1,75 cm), install a 5412403A spindle spacer ring between bottom of the mower deck and the top of the 5061033 spindle mounting ring.
2. Using the same procedure to measure the remaining spindles in the mower deck. All measurements from the bottom of the mower deck to the bottom edge of the spindle mounting ring should be the same. Additional spindle spacer rings are available at no charge through your normal parts source.

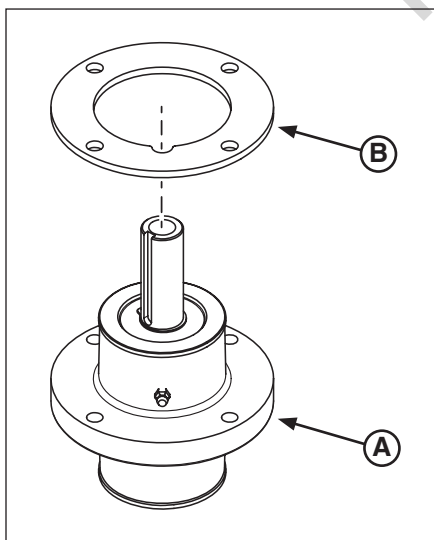

Figure 1. Part Identification

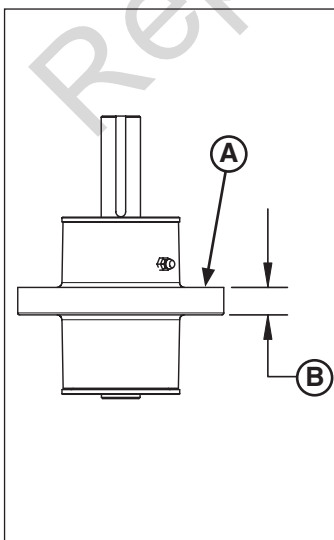

Figure 2. Measuring the Spindle

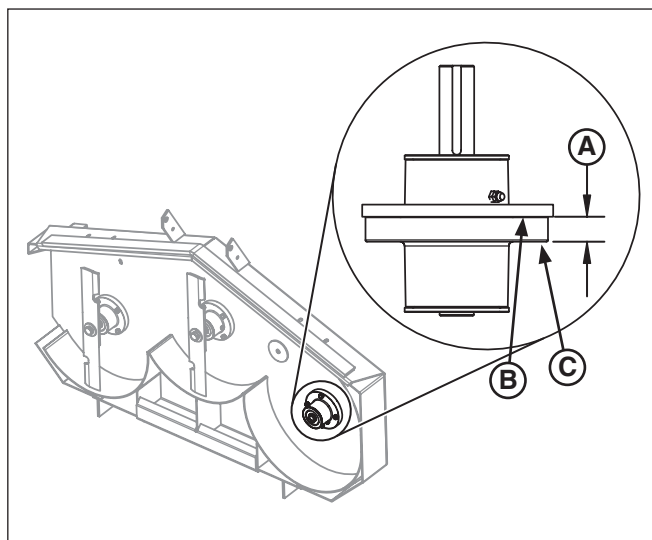

Figure 3. Measuring the Spindle in the Mower Deck

**** You can find ALL of our Product Information Sheets on The Power Portal.**