



Transmission Drive Belt Tensioning Spring Length on FW35 and FM35 Walk Behind Units

This bulletin details an inspection and correction procedure for Ferris FW35 walk-behind mowers and export versions of Ferris FM35 walk-behind flail mowers to verify that the transmission drive belt tensioning spring is adjusted to the correct length.

Brand	Model Numbers	Serial Number Range	Description
Ferris	5901231, 5901232, 5901260, 5901261, 5901262, 5901263, 5901315, 5901316, 5901317, 5901369, 5901415, 5901416, 5901417, 5901418, 5901419, 5901445, 5901446, 5901447, 5901448	2017118253 & Below	Ferris FW35 Series Walk Behind Mower
Ferris	5901453	2017118253 & Below	Ferris FM35 Export Series Walk Behind Flail Mower

Inspection:

1. Park the unit on a flat, level surface such as a concrete floor. Fully depress the neutral return pedals to return the transmissions to neutral, engage the parking brake, disengage the PTO, turn the ignition switch to OFF, and remove the ignition key.
2. Measure the coil-to-coil length (**B**, **Figure 1**) of the spring (**C**). The measurement should equal $3\text{-}3/4" \pm 1/8"$ ($9.5\text{ cm} \pm .32\text{ cm}$).
 - If the measurement **equals** $3\text{-}3/4" \pm 1/8"$ ($9.5\text{ cm} \pm .32\text{ cm}$), no further work is necessary.
 - If the measurement **does not equal** $3\text{-}3/4" \pm 1/8"$ ($9.5\text{ cm} \pm .32\text{ cm}$), perform the *Correction Procedure*.

Correction Procedure:

1. Loosen the jam nut (**D**) on the spring anchor eye bolt (**E**).
2. Turn the adjustment nut (**F**) until the coil-to-coil measurement of $3\text{-}3/4" \pm 1/8"$ ($9.5\text{ cm} \pm .32\text{ cm}$) is achieved.
3. Re-tighten the jam nut.

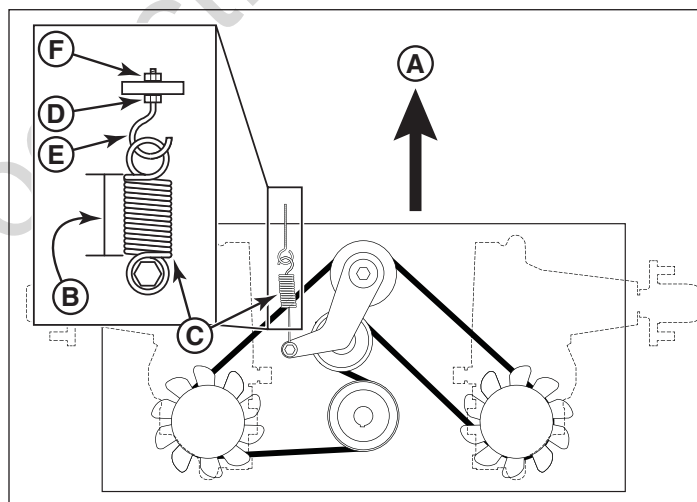

Figure 1. Checking the Transmission Drive Belt Tensioning Spring Length (This figure depicts the underside of the engine deck as viewed by looking up towards it. The arrow (**A**, **Figure 1**) indicates the front of the machine.)

**** You can find ALL of our Product Information Sheets on The Power Portal.**