



## Updated Deck Leveling Procedure for All Mowers with iCD Mower Decks

Ferris has determined that for optimal cutting efficiency it is best that all iCD Mower Decks be adjusted so that the back of the mower decks are 1/4" (0,64 cm) higher than the front.

All operator's manuals and setup instructions shipping with new equipment are updated to reflect the updated procedure for leveling the mower deck.

**For unit's that are currently in service:** Follow the instructions in the operator's manual included with the unit but when placing blocking underneath the deck add a 1/4" (0,64 cm) spacer to the blocks that are placed under the rear of the deck. Continue following the instructions detailed in the operator's manual, but adjust the deck so that the measurements from the tip of the front blade to the ground is 4" (10,2 cm) and that the measurements from the tip of the rear blade to the ground is 4-1/4" (10,8 cm).

If the instructions for leveling the deck do not require blocks being placed under the mower deck, the deck can simply be adjusted so that the measurements from the tip of the blade to the ground measure 4" (10,2 cm) in the front and 4-1/4" (10,8 cm) in the rear.

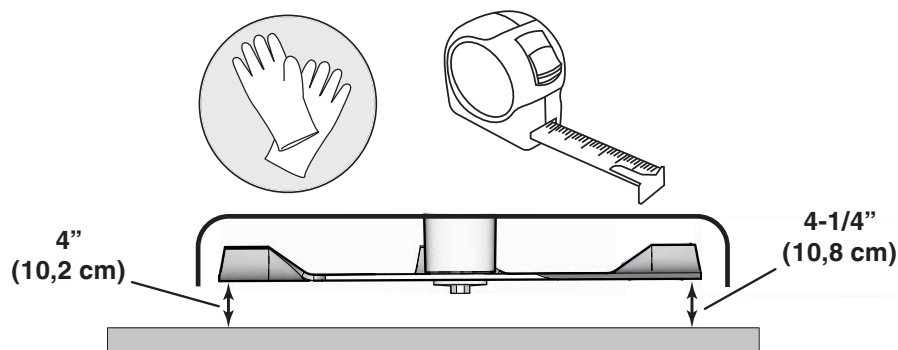
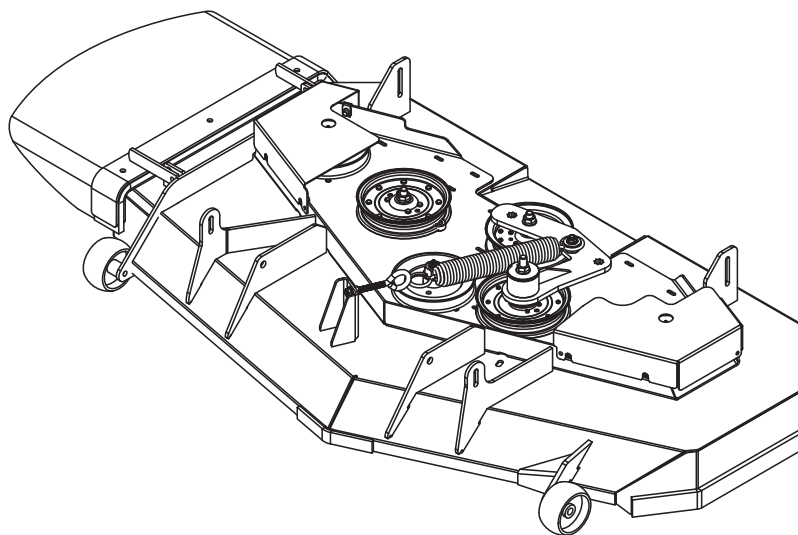

**\*\* You can find ALL of our Product Information Sheets on The Power Portal.**